

## MODEL NO. 60138 Deck-To-Deck Stairs (Single)

### PARTS LIST

DESCRIPTION	No. REQ'D	PART NUMBER
Step-To-Step Single Step Barrier Panel	2	301244
Transfer Single Step	1	300067
<b>Hardware Complete</b>	1	303084
5" O.D. Panel Clamp	4	302099*
1/4" x 3/4" Drive Rivet	4	168449*
3/8" Barrel Nut	8	804804*
3/8" Flat Washer	4	817410*
3/8" Heavy Hex Nut	4	804200*
3/8" x 1" P.B.H.C.S. w/Patch	12	812050*
3/8" x 1 1/2" P.B.H.C.S. w/Patch	4	812053*
3/8" x 3 3/4" P.B.H.C.S. w/Patch	4	812076*
3/8" Lock Nut	8	804353*
3/8" Flat Washer (1 1/4" O.D.)	20	817424*
Plastisol Coated Pipe	4	303098*

*Unless Otherwise Specified, All Units of Measure are Each  
\*Included in Hardware*

**Warning: Small parts and hardware items may present a potential choking hazard. Promptly remove all unused parts from play area.**

### SPECIFICATIONS:

Clamps are cast from a 356 high-strength aluminum alloy with a baked-on polyester powder-coated finish. Transfer Step is fabricated from pre-punched steel sheet 11-gauge thickness with steel flat support bars welded underneath to increase strength. After welding, the entire platform is Plastisol-coated with a thickness of 50 to 80 mils on top wear surface. Average perforation size is 5/16" diameter after coating. Panel is cut from a solid sheet of high-density .850" thick extruded polyethylene with color molded in and UV-stabilized.

All hardware is stainless steel.

Weight: 110 lb / 50.0 kg

### INSTALLATION INSTRUCTIONS:

1. Locate the Posts intended to receive the Deck-To-Deck Stairs. Dig footings as shown in the assembly drawing. Refer to your overhead drawing for location.
2. Attach Transfer Single Step to pre-existing decks using 3/8" x 1" P.B.H.C.S. w/Patch with 3/8" Flat Washers (1 1/4" O.D.) and 3/8" Lock Nuts as shown.
3. Attach Step Barrier Panel to Upright Posts using Panel Clamps (refer to Panel Clamp Sub-assembly sheet for details), Plastic coated Pipes, 3/8" x 3-3/4" P.B.H.C.S. w/Patch with 3/8" Flat Washers and 3/8" Barrel Nuts. Secure the lower end of panel to Transfer Single Step using 3/8" x 1" P.B.H.C.S. w/Patch with 3/8" Flat Washers (1 1/4" O.D.) with 3/8" Barrel Nuts as shown in the assembly diagram.
4. Plumb, level and brace in position the entire structure. Tighten all fasteners and pour concrete footings within 4" to the top and taper away from post to allow water drainage. Allow to cure at least 48 hours before use.

---

## MODEL NO. 60138 Deck-To-Deck Stairs (Single)

5. When the assembly is finished and satisfactory, install Drive Rivets in all clamps to ensure clamps cannot slide down posts. See Panel Clamp sub-assembly sheet. ***It is very important that all Drive Rivets be installed prior to allowing use of the equipment, as clamps are not designed to support substantial weight without them.*** Eliminate sharp points and sharp edges (burring) on installed Hardware like Bolts, Nuts, etc. Install resilient surfacing material within the use zone of play structure, in accordance with ASTM specifications F1292 appropriate for the fall height of each structure. Refer to the Safety Guidelines.

### **MAINTENANCE PROCEDURE:**

Periodically check hardware for tightness, and tighten as necessary. Always check all parts for breakage or wear, and immediately put equipment out of service until any faulty parts found are repaired or replaced. Check for rust or paint loss and touch-up if necessary with paint. Check welded areas and verify integrity. Check Plastisol-coating for bare spots and touch-up with Plastisol if necessary. Clear any trapped debris from deck perforations. Check for cracks, gouges or breakage on plastic, check for integrity of the plastic, keep plastic clean of any extraneous substances, verify that any deformation does not create entrapment as specified on ASTM F-1487 section 6. Check periodically resilient surfacing for appropriate depth and remove extraneous materials that could cause injury, infection, or disease. Maintain detailed installation, inspection, maintenance, and repair records for each public-use playground equipment.

## MODEL NO. 60138 Deck-To-Deck Stairs (Single)

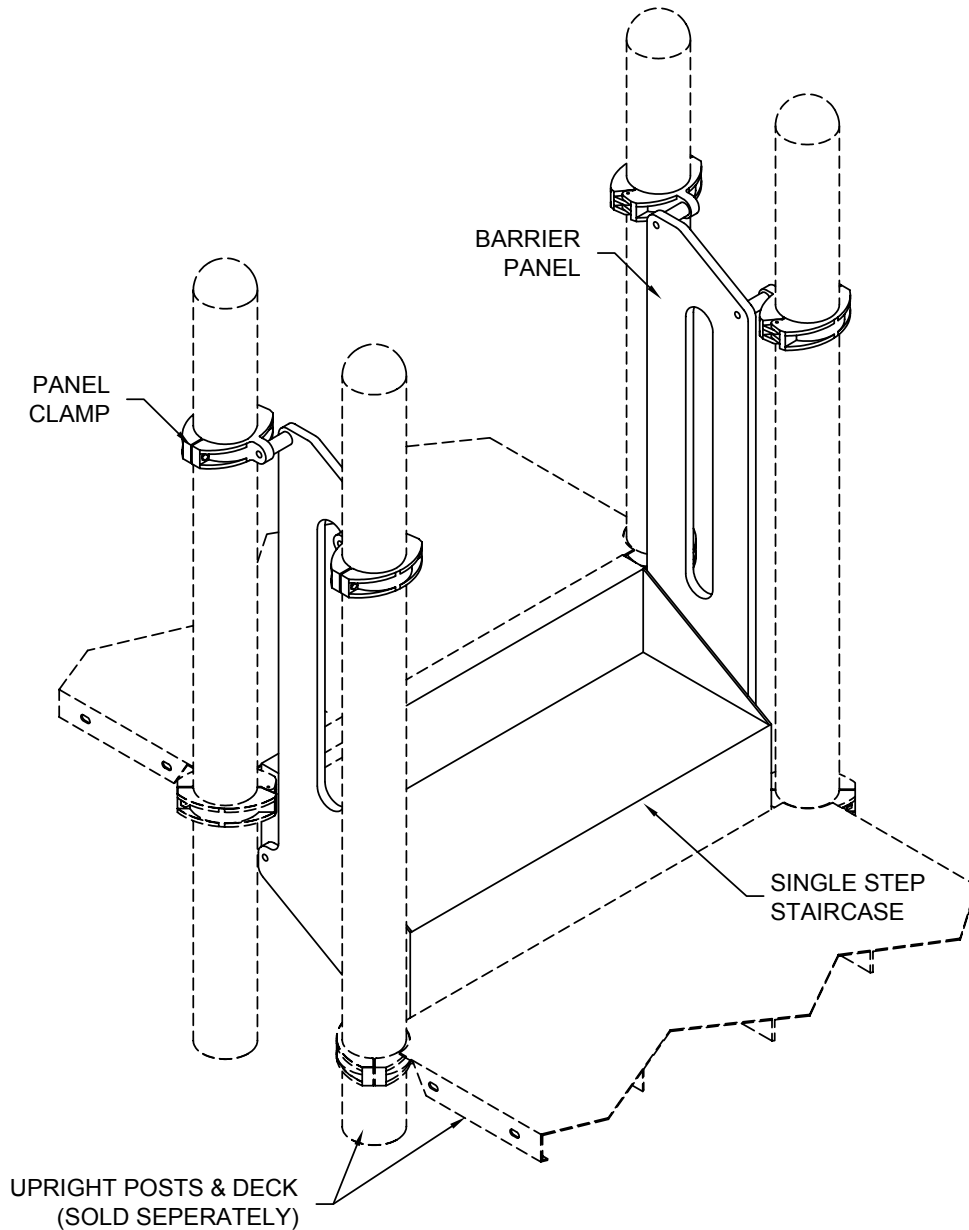

FINISHED ASSEMBLY

## MODEL NO. 60138 Deck-To-Deck Stairs (Single)

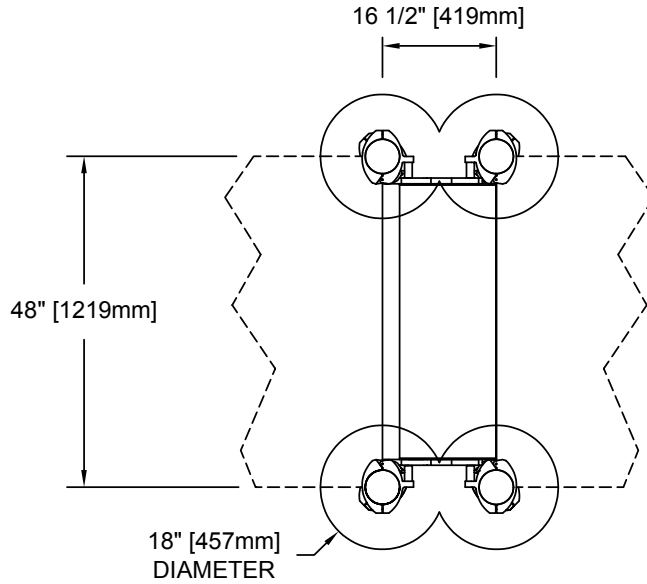

PLAN VIEW

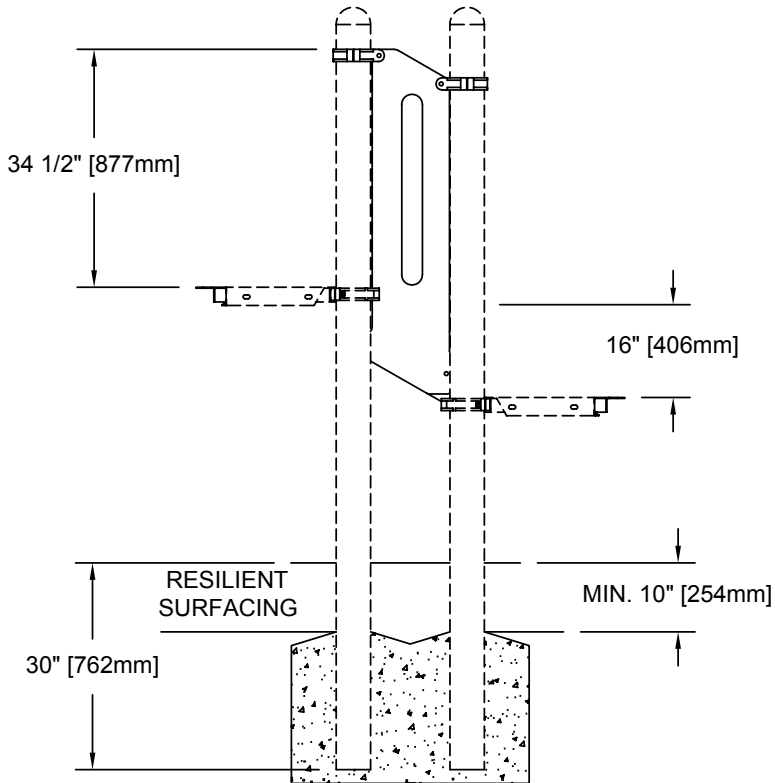

ELEVATION VIEW

## MODEL NO. 60138 Deck-To-Deck Stairs (Single)

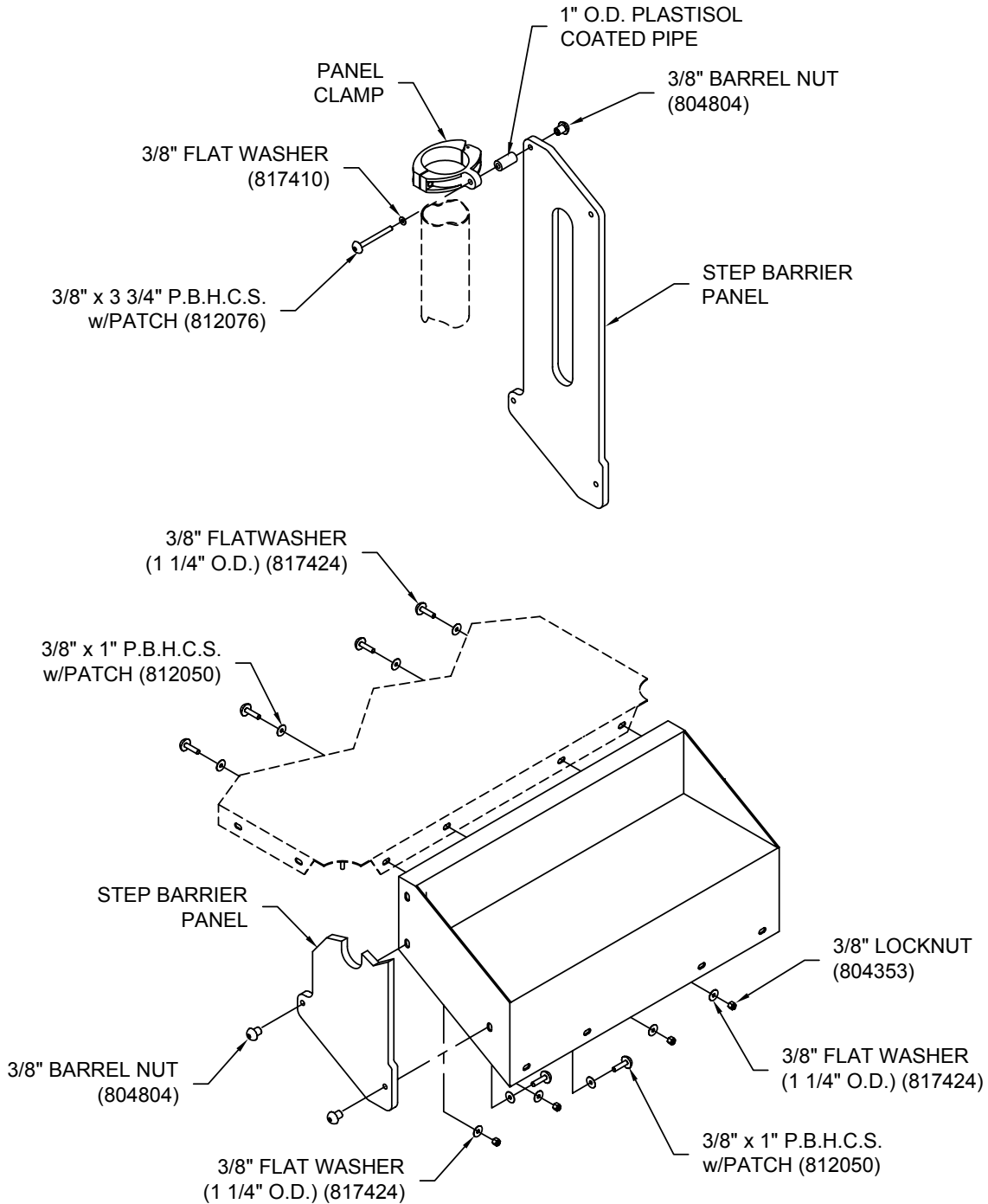

### DECK-TO-DECK STAIRS ASSEMBLY