

MODEL NO. 60144 Swivel Station

PARTS LIST

DESCRIPTION	No. REQ'D	PART NUMBER
Horizontal Beam	1	303150
Play Wheel	3	301783
Hardware Complete	1	303123
Half Clamp	3	301124*
5" O.D. Pipe Clamp	4	302030*
1/4" x 3/4" Drive Rivet	4	168449*
3/8" Flat Washer	24	817410*
3/8" Heavy Hex Nut	4	804200*
3/8" X 1 1/2" P.B.H.C.S. w/ Patch	4	812053*
3/8" X 1 1/4" P.B.H.C.S. w/ Patch	12	812051*
3/8" Lock Nut	12	804353*
3/8" x 3/8" Set Screw	4	811549*

*Unless Otherwise Specified, All Units of Measure are Each
* Included in Hardware*

Warning: Small parts and hardware items may present a potential choking hazard. Promptly remove all unused parts from play area.

SPECIFICATIONS:

Horizontal Beam is made of 3-1/2" O.D. 13-gauge galvanized steel tubing and 1-5/16" O.D. 14-gauge galvanized steel tubing all welding are stainless steel. Play-Wheels consist of 3/4" O.D. tubing, spokes are made of 1/2" rod and reinforced with a 1/8" steel plates, free turning with a grease impregnated bronzed bushing press-fit into the shaft to provide smooth turning. 3-1/2" Steel Wide Half-Clamps are formed from a 3/16" thick steel plate. All parts are polyester powder-coated finished after fabrication.

All hardware is stainless steel.

Weight: 81 lb. / 36.8 kg

INSTALLATION INSTRUCTIONS:

1. Locate the four Upright Posts intended to receive the Swivel Station by referring to your overhead drawing for location. They should be spaced 8' apart lengthwise and 4' apart widthwise.
2. Mark tops of the four Upright Posts selected to receive the Beam at approximately 66" to 84" above finished ground level. Attach a Pipe Clamp over each 49" Rung end on the Beam, and clamp onto posts at marks. Slightly tighten Pipe Clamps.
3. Attach the Play-Wheels to Horizontal Beam using 3/8" x 1-1/4" P.B.H.C.S. w/ Patch with 3/8" flat washers and 3/8" Lock Nuts as shown in the assembly diagram.
4. Once the entire play structure is assembled, and all Posts have been properly braced, level and plumb. Pour concrete within 4" to the top. Be sure to taper concrete away from Posts as shown on assembly diagram to facilitate good water drainage.
5. When the structure is finished and satisfactory, install Drive Rivets on all clamps to ensure clamps cannot slide down posts. See Pipe Clamp sub-assembly sheet. **It is very important that all Drive Rivets be installed prior to allowing use of the equipment, as clamps are not designed to support substantial weight without them.** Install resilient surfacing material within the use zone of play structure in accordance with ASTM specifications F1292 appropriate for the fall height of each structure. Refer to the *Safety Guidelines*.

MODEL NO. 60144 Swivel Station

MAINTENANCE PROCEDURE:

Periodically check hardware for tightness, and tighten as necessary. Always check all parts for breakage or wear, and immediately put equipment out of service until any faulty parts are repaired or replaced. Check all decks for Plastisol-coating peeling and touch-up with Plastisol if necessary. Check for holes on deck, clean if necessary. Check periodically resilient surfacing for appropriate depth and remove extraneous materials that could cause injury, infection, or disease. Maintain detailed installation, inspection, maintenance, and repair records for each public-use playground equipment.

MODEL NO. 60144 Swivel Station

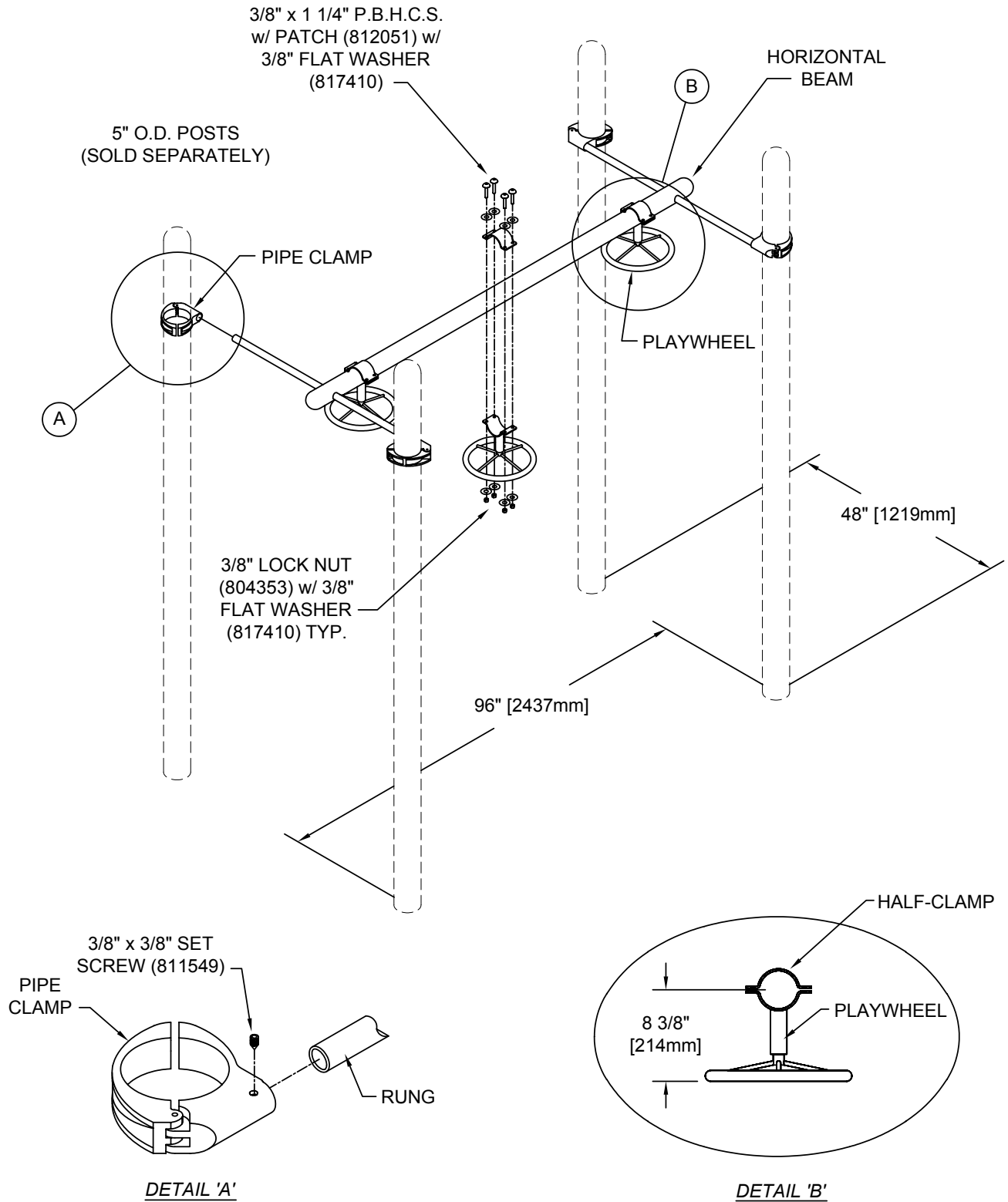

MODEL NO. 60144 Swivel Station

